

German Fuel Cart

Assembly instruction

Designed and developed by Filip Rzaša

PPX-001

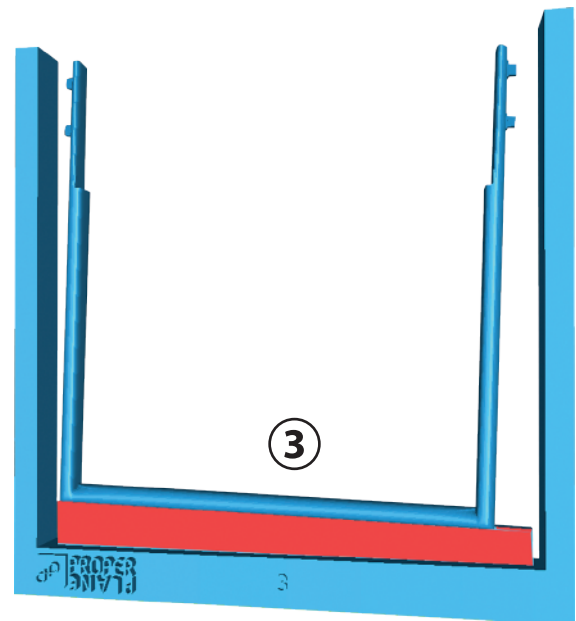
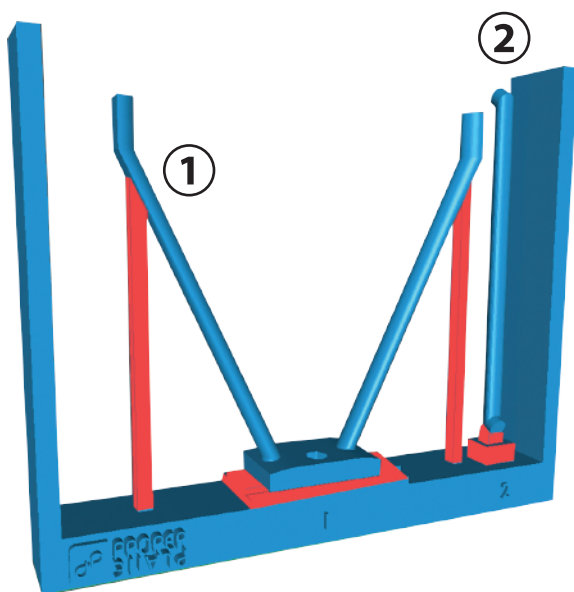

Before starting the assembly all the parts should've be removed from the frames and print supports. Print supports are marked with red. Cut the parts off with a knife with sharp blades.

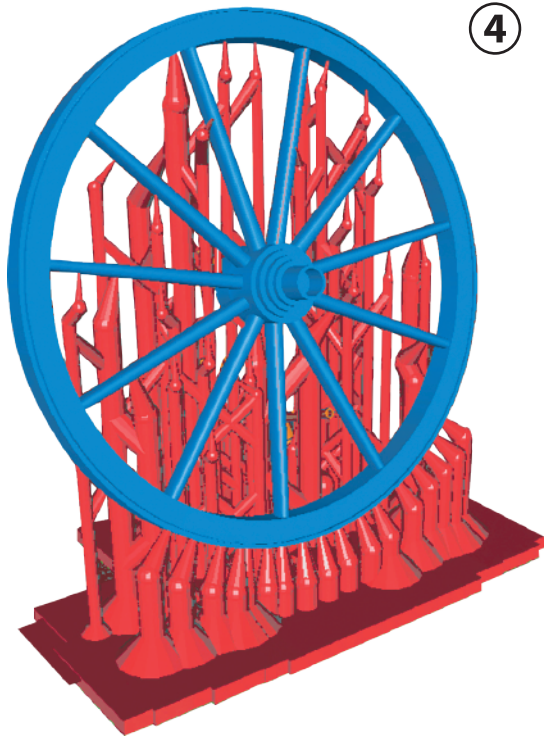

All the print supports marked with red should've be removed from the parts.

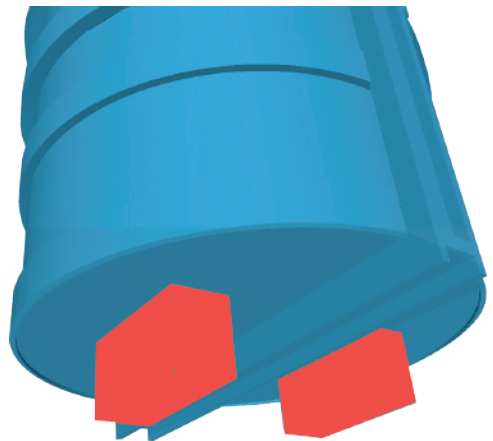
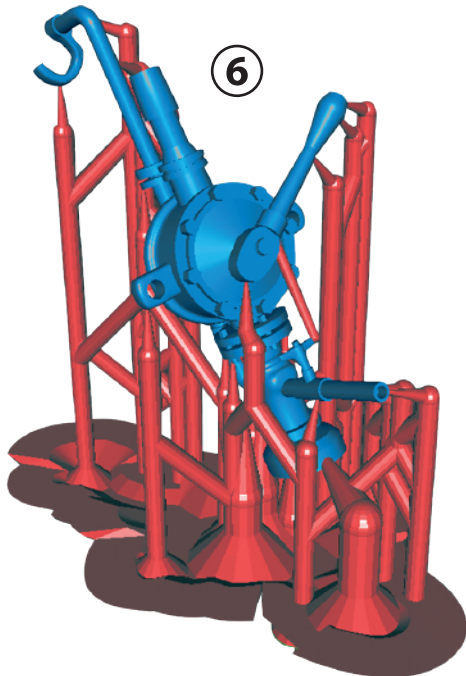

Remove the red marked supports from the barrel part.

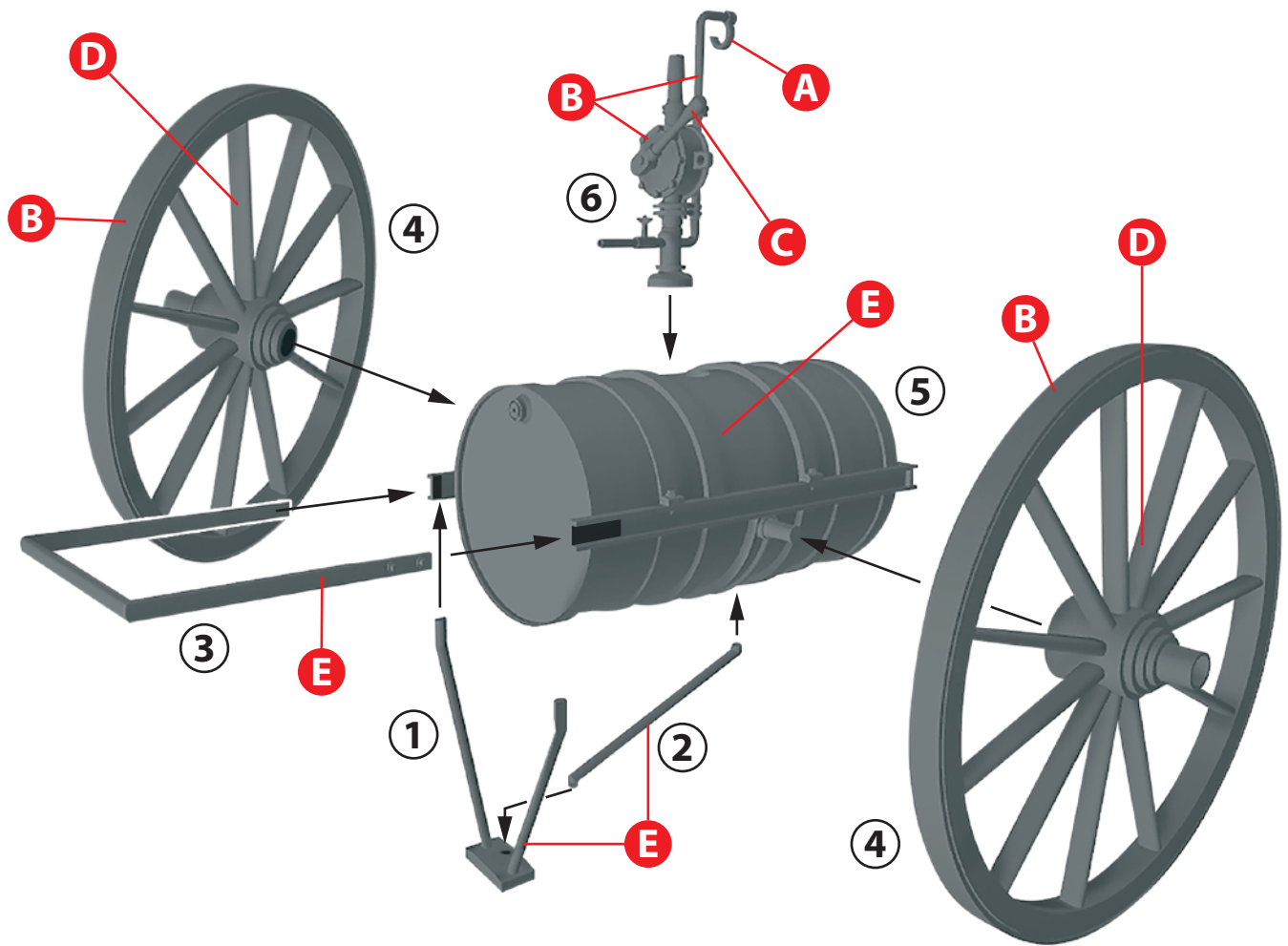

Assembly the parts as shown on the instruction. Use the suggested colors and the picture of the assembled barrel as a reference.

